

From hospital to home

vivo
by Breas

vivo[®]
by Breas

Design for life

The Vivo 50* life-support ventilators combine high quality technology, robustness and premium design to treat patients independent of the environment.

Thanks to the user-friendly configuration of pressure and volume regulated modes, the treatment can be personalized to the patient's needs. The Vivo 50 offers the possibility to use a leakage circuit when applying VCV (Volume Control Ventilation). This, together with eSync** technology and a full range of settings, leads to a strong combination of performance and flexibility.



Maximal flexibility of operation by the multiple types of circuits for both invasive and non-invasive ventilation.

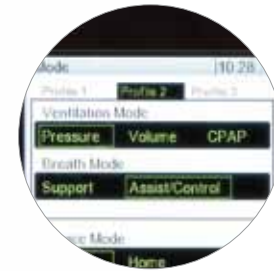

As we care about comfort and flexibility the Vivo ventilator offers the possibility to pre-set up to three ventilation profiles. This allows the patient to benefit from the optimal treatment at any time during the day.

We care ...

Full monitoring allowing view of waveforms, numerical data and trend monitoring.

Developed out of the market needs, there is the possibility to connect a patient start/stop function, remote alarm, nurse call system.

Easy direct access to the menus on the user-friendly front panel.

Freedom of operation thanks to a 4 hour internal battery and the option of an additional 8 hours from the click-on battery.

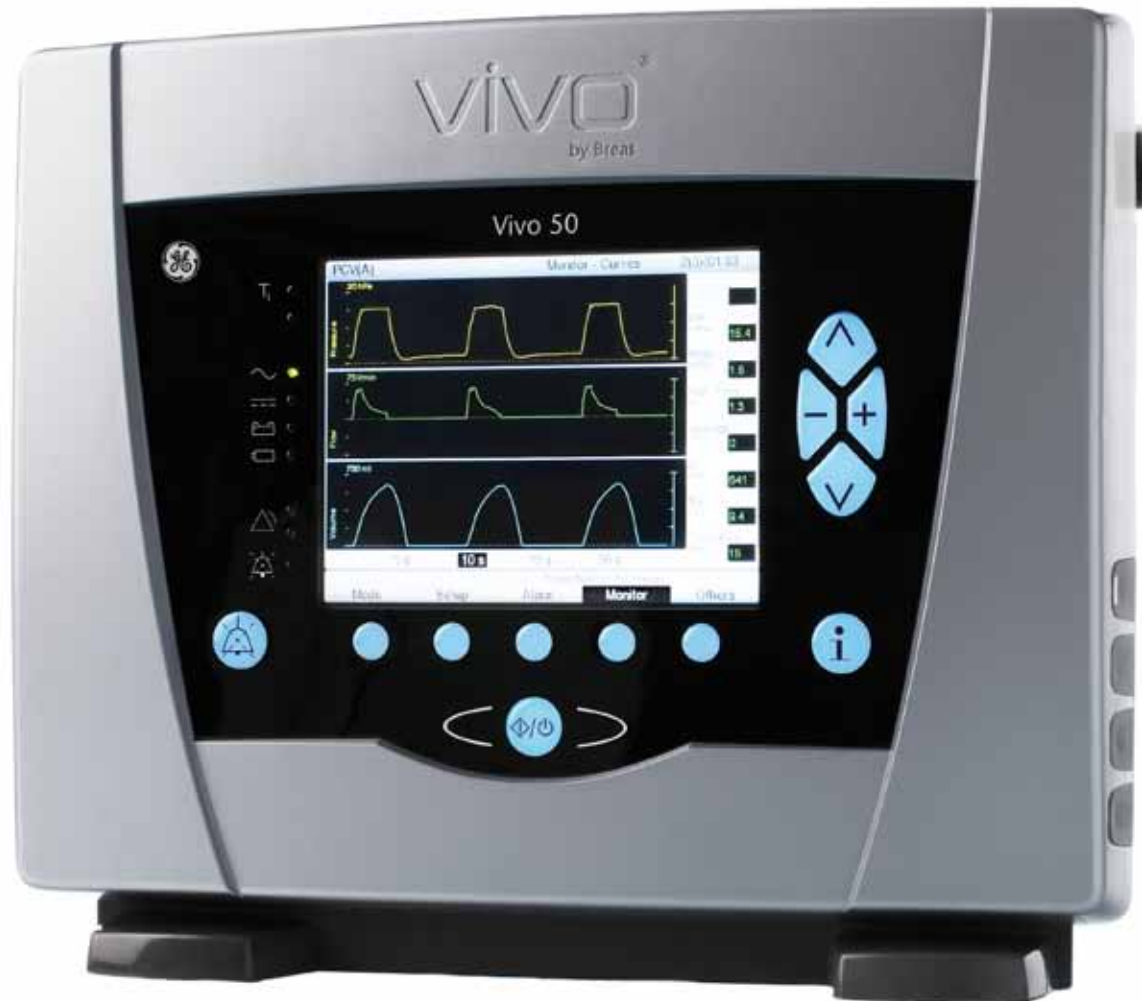

Can be used with circuits for both invasive and non-invasive ventilation.

The FiO_2 , SpO_2 and CO_2 sensors give the unit high-end monitoring capabilities with on-screen values and alarms.

The *i*-button makes information on alarms, settings and troubleshooting available.



i-button to provide explanations at a click.



Intuitive user interface with single-screen set up. The large color screen with distinct buttons gives direct access to main menus.

Ease of use

Breas has always recognized ease of use and an intuitive user-interface as top priorities for patients and clinical staff. Therefore, the Vivo 50 features a full color screen and distinct buttons to provide easy access to all functions.

The menu structure is simple and effective with an exceptional i-button that provides explanations of functions and alarms at a click. These features have been incorporated to help increase patient comfort, save time and reduce the risk for mistakes. This makes the Vivo 50 easy to learn, easy to operate and easy to explain.



Easy-to-read information of FiO_2 , SpO_2 and CO_2 values.



The advanced PC software enables on-line monitoring with wave forms, trends and numerical data.

Extensive Monitoring

The extensive monitoring capabilities of the Vivo 50 provide the physician with ample possibilities to define and control the treatment. The Vivo 50 is equipped with FiO_2 , SpO_2 and CO_2 monitoring solutions, is typically reducing the need for additional devices to an absolute minimum. The large full color screen helps the physician to easily read the set parameters, wave forms, numerical data and trends. Up to one year of treatment data are stored in a central memory with the possibility to download data onto a memory card. Additionally, advanced PC software is available to enable on-line monitoring and analysis of treatment data.





The trolley provides a stable and convenient placement of the Vivo 50.



The ergonomic design makes the Vivo 50 easy to carry and to handle.

From hospital...

As the ventilation starts in the hospital, high performance has been the first priority of the Vivo 50. The Vivo 50 can be operated in volume or pressure controlled modes, with leakage or exhalation valve circuits. Three different profiles can be defined to optimize the treatment to various needs.

The Vivo 50 has multiple alarms plus the possibility to connect a remote alarm and a nurse call function. Other accessories, like the mounting bracket and trolley facilitate usage of the Vivo 50 in the hospital.



The remote alarm can be placed in an adjacent room.



The exceptional home-adjust setting provides excellent patient comfort.

...to home

After the hospital, the ventilator needs to fulfill different requirements at the patient's home. Of primary concern is a strong feeling of security and acceptance in the home environment. With this understanding, Breas brought together high performance features, premium Scandinavian design and a low noise level in the Vivo 50. The home-adjust setting is one of the exceptional features to increase patient comfort. It allows the patient to adjust specific parameters within limits set by the physician. Similarly, the design takes into consideration the ease of use and technical solutions for improved quality of life. The ergonomic design of the Vivo 50 make the device easy to handle. Moreover it is one of the most silent devices on the market.



BOUTIQUE CHOCOLAT & SERVERING





Easy operating thanks to the remote start/stop.



The 8 hour Lithium-Ion Click-on battery is easy to replace and recharge.



The protective cover gives protection on outdoors activities.



The Vivo 50 has a durable and protective casing.

Active Daily Life

Thanks to modern ventilator technologies, many patients are able to live an active life outside the home. However, mobile use sets high demands on autonomy, durability and robustness. The Vivo 50 has been developed to meet these demands and offers an extensive range of accessories. The combination of the internal battery and click-on battery offers 12 hour autonomy with only 3 hours charging time. Additionally, thanks to the Hot Swap function the click-on battery can be replaced while the device is running. Further accessories such as the remote start/stop enable the patient to easily operate the Vivo 50 from the wheelchair.

Robustness

Robustness is a key benefit of the Vivo 50. The casing including the buttons is highly durable and protective. A special protective cover provides protection for use on a wheelchair outside the home.

The robust design is an important element to ensure the durability and cost effectiveness of the Vivo 50. Altogether, the Vivo 50 offers a ventilator you can rely on, independent of the environment.

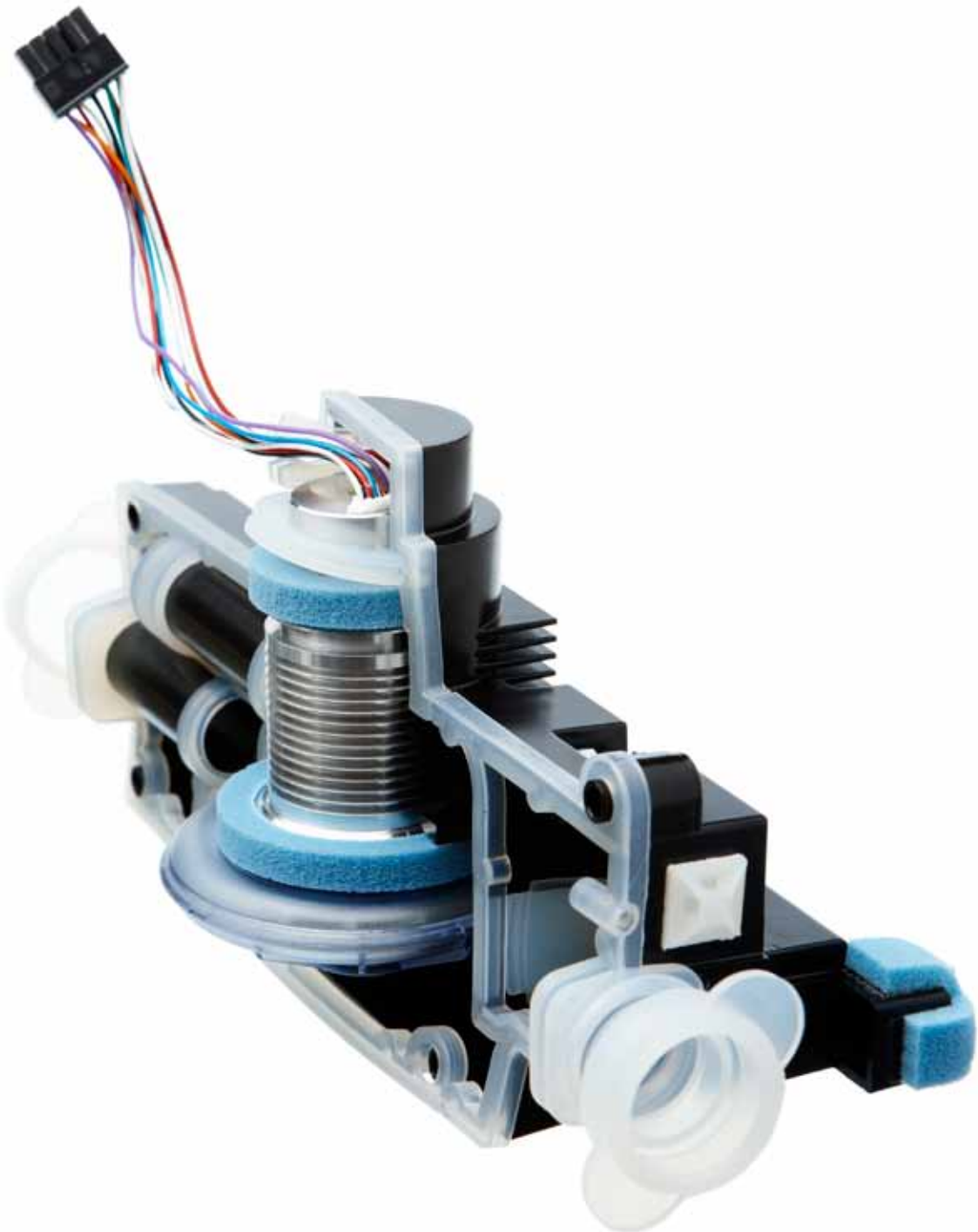

Energy management is of highest importance to control the high-performance blower. Energy released from braking the blower is stored and used to accelerate in the next moment.



The clean, modular internal layout is designed for easy access and cost effective service.

Premium Technical Design

Premium Scandinavian design is not restricted to the outside of the Vivo 50. Also the inside is the result of careful design combined with the latest electronic technology.

The separate cooling airflow assures an optimal temperature control inside the devices. Energy management is of highest importance to control the high-performance blower. Energy released from braking the blower is stored and used to accelerate in the next moment. The Vivo 50 fully complies with RoHS requirements on avoidance of hazardous materials. Together, this makes the Vivo 50 a remarkable ventilator that combines performance, durability and easy, cost effective servicing.



Trolley



iOxy/SpO₂



CO₂



Oxygen/FiO₂



Protective cover



Remote alarm



8 hour Lithium-Ion
Click-on battery

Accessories

Breas acknowledge the need not only to offer a remarkable ventilator but also to enhance comfort and ease-of-use for the patient and clinical staff. Therefore, the Vivo 50 range includes an extensive package of accessories for use in the hospital and in the home environment. The nurse call cable, the remote alarm and the trolley are suitable accessories at the hospital. The click-on battery (plus external charger), the remote start/stop and the protective cover are examples of valuable accessories at home. A full overview of accessories is available separately.

Technical Specifications

Specifications	Vivo 50
Patients > 10 kg	•
Pressure max, (cmH ₂ O)	50
Tidal volume (ml)	100-2500
Modes:	
CPAP	•
PSV, PSV (TgV)	•
PCV, PCV (A), PCV (TgV), PCV (A+TgV)	•
VCV, VCV (A)	•
Target volume	•
O ₂ bleed-in, low flow/pressure	•
Single limb circuit with leak or exhalation valve	•
Internal battery, Li-Ion ^{***}	4h
Click-on battery, Li-Ion	8h
FiO ₂ monitoring	•
SpO ₂ monitoring	•
CO ₂ monitoring	•
Sigh Function	•

* Vivo by Breas is a trademark of General Electric Company

** eSync is a trademark of General Electric Company

*** Depending on the device settings

© 2012 General Electric Company - All rights reserved.

General Electric Company reserves the right to make changes in specifications and features shown herein, or discontinue the product described at any time without notice or obligation. Contact your GE representative for the most current information.

GE, the GE Monogram and imagination at work are trademarks of General Electric Company.

BREAS
A GE Healthcare Company

Breas Medical AB · Företagsvägen 1 · SE-435 33 Mölnlycke · Sweden
Phone +46 31 86 88 00 · Fax +46 31 86 88 10 · breaswe@ge.com · www.breas.com



Accessories

Accessories	Vivo 50
Leakage circuit	•
Single limb circuit with active exhalation valve	•
Carry bag	•
Protective cover	•
Remote alarm	•
Remote start/stop and mute	•
Cable for Nurse call alarm	•
12 to 24 VDC converter	•
External battery cable 24 V DC	•
8 hour Li-Ion Click-on battery	•
AC charger for 8 hour Li-Ion Click-on battery	•
Mounting bracket	•
Trolley	•
Support arm for patient circuit	•
Vivo 50 PC software (online monitoring, analysis of treatment data)	•
iOxy/SpO ₂	•
SpO ₂ sensor	•
CO ₂ sensor	•
FiO ₂ sensor	•

Dimensions	Vivo 50
W x H x D	348 x 120 x 264 mm 348 x 120 x 290 mm with click-on battery
Weight	5.2 kg 6.7 kg with click-on battery
Noise level (at 10 cmH ₂ O constant pressure)	Less than 30 dB(A)